

Thursday, September 19, 2019 10:02:34 AM E:\2019\19018.05\Food Lion Store 1458\Level 01\Design\Construction Set\1458.A1.05\_00.dwg

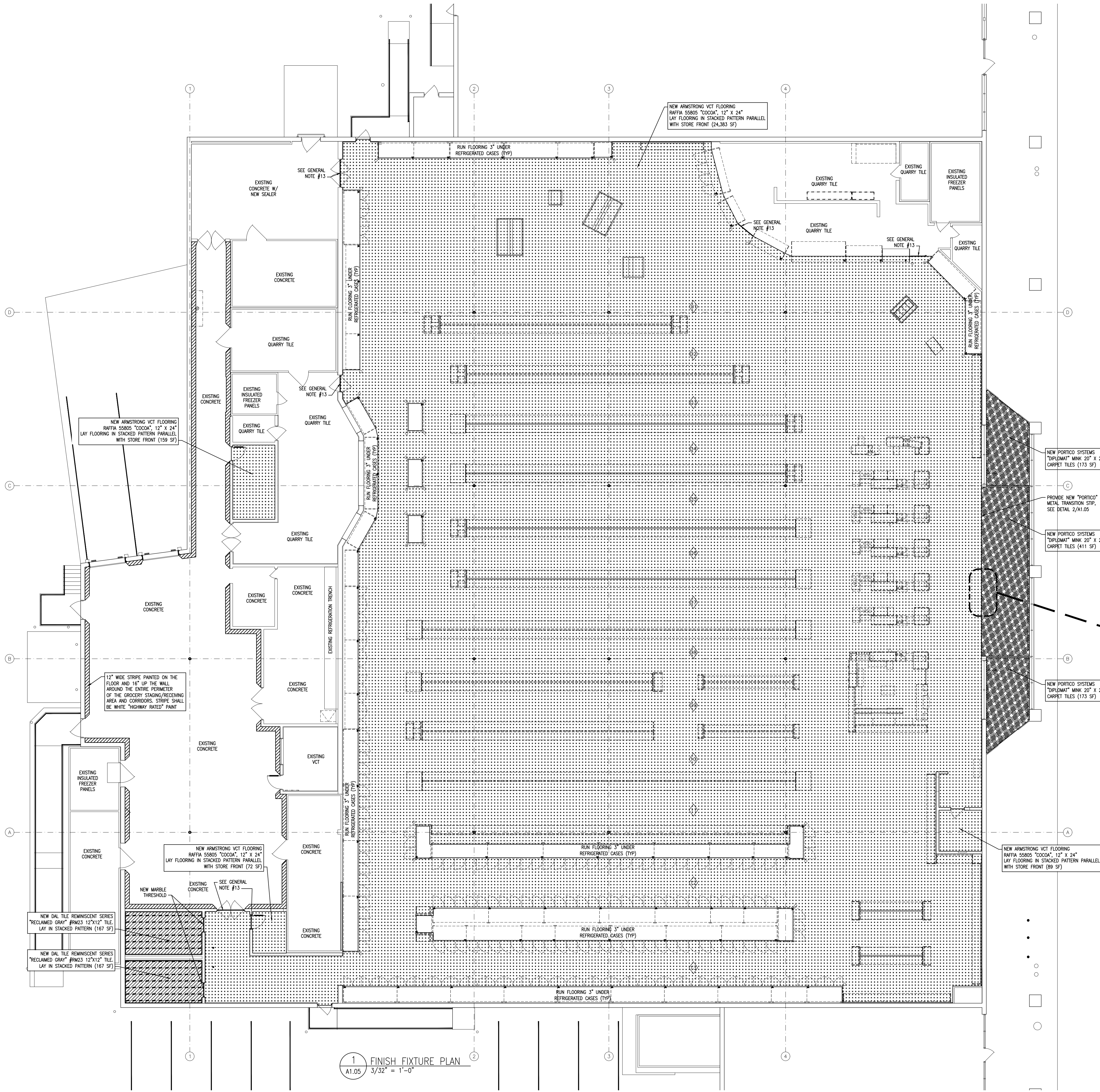

#### FLOOR FINISH LEGEND:

- REFER TO SPECIFIC AREA NOTE FOR  
DETAILED FLOORING INFORMATION
- NEW PERIMETER/FULL  
VCT FLOORING
  - NEW RESINOUS  
DECORATIVE FLOORING
  - NEW PORCELAIN TILE
  - NEW CARPET TILES
  - 12" WIDE PAINTED RAT STRIPE

#### GENERAL FLOORING NOTES:

- VINYL FLOOR TILE (VCT)
- SEE SPECIFICATIONS FOR ACCEPTABLE ADHESIVE FOR VINYL COMPOSITION TILE (VCT).
- THE VINYL COMPOSITION TILE SHALL BE 1/8" MANUFACTURED BY ARMSTRONG.
- THE GENERAL CONTRACTOR SHALL THOROUGHLY CLEAN AND WAX (2 COATS MINIMUM) VCT IMMEDIATELY AFTER INSTALLATION. ONLY USE CLEANER AND WAX PRODUCTS RECOMMENDED BY THE FLOOR MANUFACTURER.
- THE FLOORING INSTALLER SHALL PERFORM A CALCIUM CHLORIDE OR HUMIDITY TEST FOR EACH 1,000 SQUARE FOOT AREA WHERE FLOORING WILL BE INSTALLED. THE INSTALLER SHALL PROVIDE A REPORT TO THE FOOD LION CONSTRUCTION REPRESENTATIVE FOR ALL AREAS THAT MOISTURE FALLS ABOVE 5 POUNDS, AND PROVIDE AN APPROPRIATE DAMP PROOF MEMBRANE.
- THE GENERAL CONTRACTOR SHALL ALTERNATE THE FIELD TILES:
- CARPET/MAT TILE
- ENTRANCE FLOOR TILE SHALL BE "DIPLOMAT" BY PORTICO SYSTEMS WITH TAC FAST BACKING. COLOR SHALL BE "MINI". DIPLOMAT SHALL BE INSTALLED BY PORTICO SYSTEMS. CONTACT GREG GRIFFIN (864) 527-3148. THE GENERAL CONTRACTOR SHALL FURNISH 5% EXTRA OF THE TOTAL AMOUNT OF DIPLOMAT USED, TO BE LEFT IN THE BACK ROOM OF THE STORE FOR FUTURE USE.
- PHARMACY CARPET, WHEN APPLICABLE, SHALL BE "DIPLOMAT" BY PORTICO SYSTEMS WITH TAC FAST BACKING. COLOR SHALL BE "MINI". DIPLOMAT SHALL BE INSTALLED BY PORTICO SYSTEMS. CONTACT GREG GRIFFIN (864) 527-3148. THE GENERAL CONTRACTOR SHALL FURNISH 5% EXTRA OF THE TOTAL AMOUNT OF DIPLOMAT USED, TO BE LEFT IN THE BACK ROOM OF THE STORE FOR FUTURE USE.
- CONCRETE FLOORING
- ALL PRODUCTS FOR UNDERLAYMENT OF VCT SHALL BE MAPEI TO PROVIDE A COMPLETE MAPEI SYSTEM. SEE SPECIFICATIONS.
- IN AREAS WHERE FLOOR DRAINS OCCUR, THE FINISH FLOOR SHALL SLOPE 1/16" PER FOOT TO DRAIN.
- SEAL ALL EXPOSED CONCRETE FLOORS WITH AN EXTRA COAT OF CONCRETE SEALER ONE WEEK PRIOR TO GROCERY DELIVERY. SEALER TO BE PER SPECIFICATIONS. COORDINATE WITH FOOD LION CONSTRUCTION MANAGER.
- THE GENERAL CONTRACTOR SHALL USE 10 MIL VAPOR RETARDER AT CONCRETE SLAB EDGES AND 30 LB. FELT AROUND INTERIOR COLUMNS. NO EXPANSION JOINT MATERIAL SHALL BE USED.
- THE GENERAL CONTRACTOR SHALL INSTALL A 5" WIDE 11GA (1/8" THICK) STAINLESS STEEL THRESHOLD WITH COUNTERSUNK SCREWS AND SET IN A FULL BED OF SILICONE TO THE FLOOR FOR DISSIMILAR FLOOR FINISHES (RESINOUS FLOOR AND CONCRETE, VCT AND CONCRETE, RESINOUS FLOOR AND VCT, QUARRY TILE & VCT). GC SHALL INSTALL A BEVELED ADA COMPLIANT MARBLE THRESHOLD AT RESTROOM DOORS (4' WIDE x 5/8" HIGH).
- EXTERIOR SURECRETE APPLICATION SHALL BE SURECRETE DESIGN PRODUCTS "SURESPRAY PEBBLE TEXTURE" COLOR "FL100". GC SHALL SEAL WITH SUREDECK SOLVENT-BASED OR SURESEAL WATER-BASED PIGMENTED SEALER.
- RESINOUS DECORATIVE FLOORING
- RESINOUS FLOORING TO TAPER OFF FLUSH WITH CONCRETE BEHIND COOLER PANEL. DO NOT INSTALL A METAL TRANSITION STRIP.
- RESINOUS DECORATIVE FLOORING SHALL BE PURCHASED FROM DUE-A-FLEX INC. CONTACT KEVIN STEPHENS AT (919) 208-8662 OR FROM PROTECTIVE INDUSTRIAL POLYMERS, CONTACT STEVE MCCAMEY AT (804) 937-5000.
- COORDINATE RESINOUS FLOOR LAYOUT WITH CASE INSTALLER
- QUARRY/CERAMIC/PORCELAIN TILE
- THE GENERAL CONTRACTOR SHALL CLEAN ALL EXISTING TILE IN THE RESTROOMS, MEAT PREP, MEAT COOLER, MEAT STORAGE, DELI/BAKERY PREP, DELI/BAKERY COOLER AND DELI/BAKERY STORAGE. ANY REPAIR OR RENOVATIONS TO BE DONE WITH MATCHING MATERIALS. COORDINATE ALL WORK WITH THE PLUMBING, SLAB AND DEMO PLANS ALONG WITH THE FOOD LION CONSTRUCTION MANAGER PRIOR TO COMMENCING WORK.
- INSTALL NEW QUARRY, CERAMIC OR PORCELAIN TILE AT A 90° ANGLE TO THE WALL, UNLESS OTHERWISE NOTED; LEVEL WITH FINISHED FLOOR. MATCH EXISTING.
- RESTROOMS, MEAT PREP, MEAT COOLER, MEAT STORAGE, DELI/BAKERY PREP, DELI/BAKERY COOLER AND DELI/BAKERY STORAGE SHALL HAVE EPOXY GROUT CONFORMING TO TGA ANSI HT, ANSI A118.3, FOR ANY REPAIR/REMODEL WORK.
- FLOOR TILE MANUFACTURER SHALL PROVIDE A LETTER CERTIFYING ALL TILES ARE SLIP RESISTANT IN ACCORDANCE WITH CADO/ANSI 117.1-2009 SECTION 302.

NEW ARMSTRONG VCT FLOORING  
RAFFIA 55805 "COCO", 12' x 24'  
LAY FLOORING IN STACKED PATTERN  
PARALLEL WITH STORE FRONT

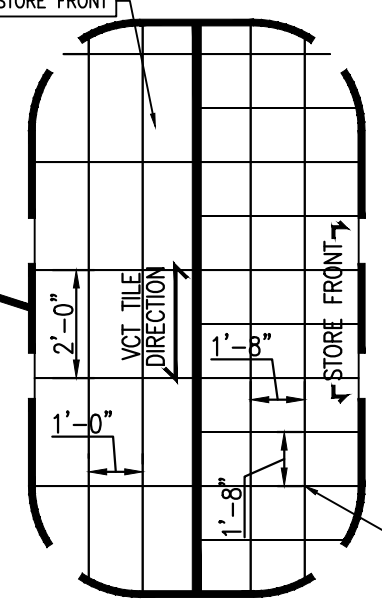

3 ENLARGED FLOORING DIRECTION DETAIL  
SCALE: N.T.S.

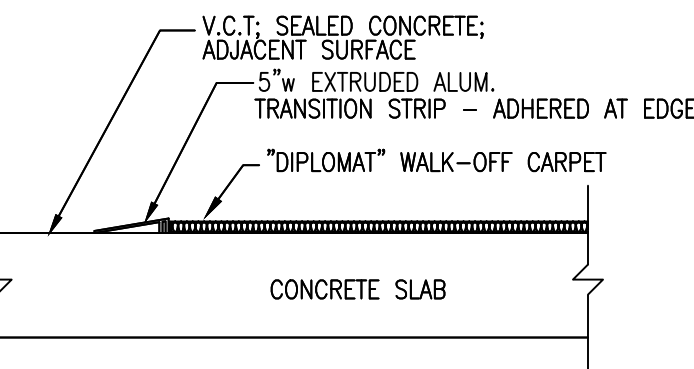

2 CARPET TRANSITION DETAIL  
SCALE: N.T.S.

1 FINISH FIXTURE PLAN  
3/32\"/>



Architecture  
Interior Design  
Land Planning  
Project Management

#### Professional Seals

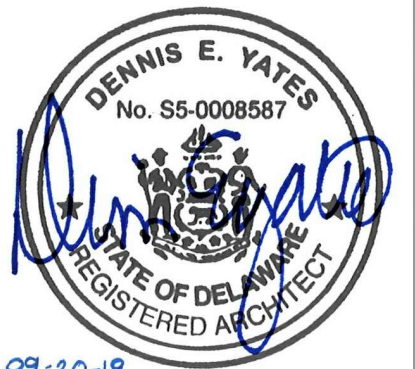

09-20-19

Interior Alteration For:



2110 Executive Drive, Salisbury, NC 28145 / PH: 704.633.8250

Store No. 1458  
30214 Sussex Hwy  
Laurel, DE 19956

OWNERSHIP OF INSTRUMENTS OF SERVICE:  
All reports, specifications, plans, computer files, field data, notes, and other documents and instruments of service shall remain the property of the Design Professional. The Design Professional shall retain all common law, statutory and other reserved rights, including the copyright therein.

This drawing is the property of Yates - Chelitzberg - Hughes Architects and is not to be reproduced or copied in whole or any part. It is not to be used on any other project and is to be returned upon request.

© Copyright 2019

Project No.: 1458FLMK20

File Name: 1458 A1.05\_00.dwg

Date: 09-20-19

Revisions:

FINISH FLOOR PLAN

Architectural  
A1.05

YCH Commission Number

19018.00

7035 Northwinds Dr NW

Concord, NC 28027

704 . 788 . 2000

ycharch.com